

Ultra-Sorb Model MP Replacement Parts

FIGURE 28-1: ULTRA-SORB MODEL MP REPLACEMENT PARTS

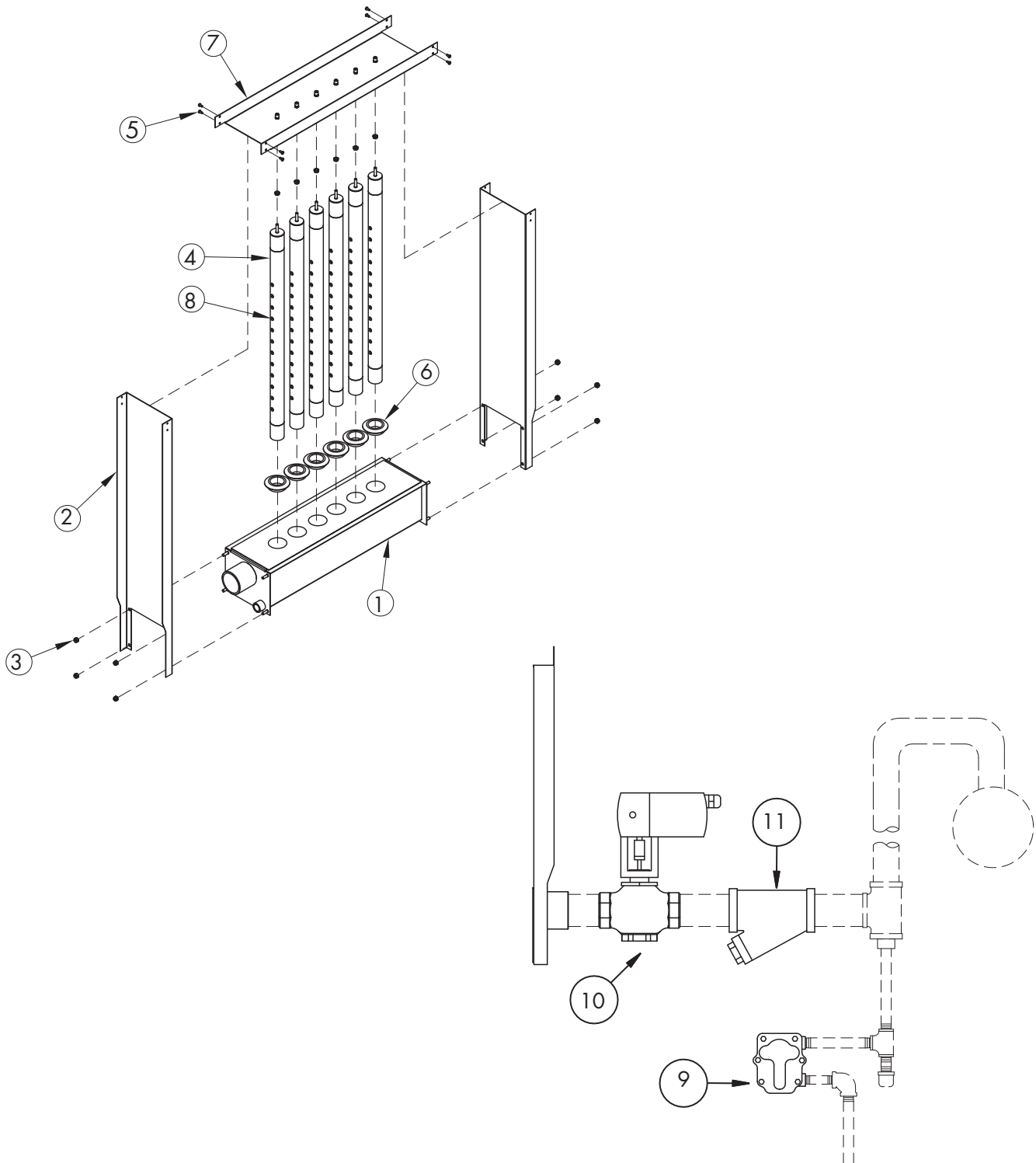

Replacement parts

Note:

Consult factory for Ultra-sorb Model MP replacement parts.

Table 29-1: Ultra-sorb Model MP replacement parts		
No.	Description	Part number
1	Ultra-sorb Model MP header	Consult factory
2	Flange side Ultra-sorb Model MP	Consult factory
3	Nut lock ¼" 20 UNC Hex Nylock SST	191172-010
	Nut lock ¼" 20 UNC Hex Nylock plated	191170-035
4	1½" (38 mm) high-efficiency insulated dispersion tube	Consult factory
	1½" (38 mm) high-efficiency non-insulated dispersion tube	Consult factory
	2" (50 mm) high-efficiency insulated dispersion tube	Consult factory
	2" (50 mm) high-efficiency non-insulated dispersion tube	Consult factory
5	Screw #8 32 x 3/8" PHL PNHD DRV Type F stainless steel (SST)	191172-015
	Screw #8 32 x 3/8" PHL PNHD Type F	191172-020
6	Grommet for 1½" (38 mm) dispersion tube	405895-150
	Grommet for 2" (50 mm) dispersion tube	405895-200
7	Frame top, Ultra-sorb Model MP, split over, 144" (3658 mm) width	Consult factory
	Frame top, Ultra-sorb Model MP, to 144" (3658 mm) width	Consult factory
8	Tubelet	Consult factory
9	Steam trap	Consult factory
10	Steam valve	Consult factory
11	Strainer	Consult factory